

The Thermo Scientific Electronics Upgrade Package provides a flexible solution to obsolescence issues of older gauging electronics. The package will maximize your return by extending the life of sensors you trust without compromising the level of reliability and maintainability you need.

Thermo Scientific Electronics Upgrade Package

Modernization of Processing Electronics

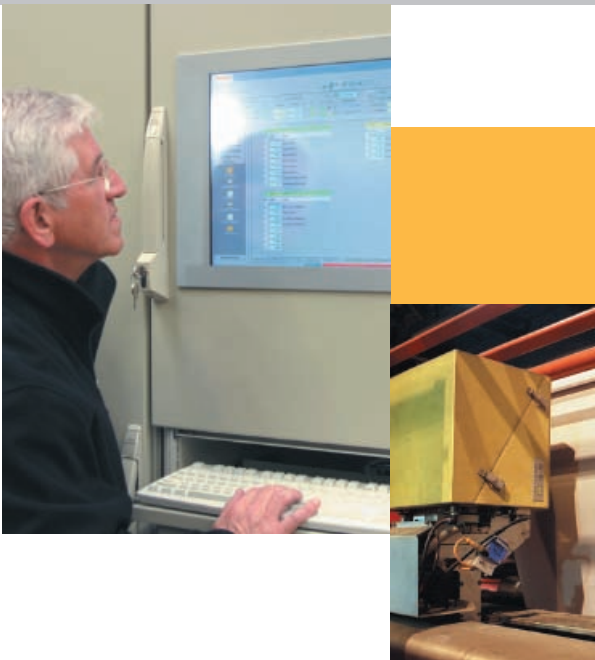

Benefits

- Cost-effective solution to extend sensor life
- Reuse of existing sensor components
- Portability of calibration data
- Elimination of electronics obsolescence concerns
- Recertification of sensors
- Versatility in electronics design
- Retention of existing communication and input/output links
- No engineering/installation costs for measuring mechanism

Our engineers have identified the many historical gauging product models offered over the years whose working life would be extended by the Thermo Scientific Electronics Upgrade Package. These former brand names are Boyle, Daystrom, DMC, Eberline, FAG, Loral, Nucléomètre, Radiometrie, THI, and Weston. The result is an electronics upgrade design that is based on the latest modular processors and digital and analog interfaces. In addition, our flexible electronics platform can also be adapted to gauge models from many other suppliers.

The evolution of microprocessor technology and personal computers over the last decades has rendered many gauge computers obsolete while their C-frames, scanners and associated sensors are still providing state-of-the-art performance. And as many board level electrical components become obsolete, sustaining engineering costs grow significantly, making the Electronics Upgrade Package both an attractive and logical choice.

Designed to connect directly to the sensors, the Electronics Upgrade Package is the cost-effective option to extend sensor life. While it is possible to disconnect the old electronics and reuse everything from the interconnections to the scanner (O-frame or C-frame) and sensors, the benefit of the upgrade package is that it can be tailored for your specific needs.

Features

- Industrial-proven modular design
- Maintenance-friendly terminations
- Incorporation of latest compensation algorithms
- Interface links (Ethernet TCP/IP, serial, OPC, Profibus, etc.) to host computer
- User-friendly operator interface
- Process capability check
- Direct over-the-phone remote access and diagnostics
- Production report package
- Fault location detection

Isotope, Infrared and X-Ray Gauges

When considering an upgrade for your production line, the Electronics Upgrade Package is the ideal option. All of the measurement algorithms, motion modes and standard host interfaces have been included in the gauge software. The Thermo Scientific Enhanced Processing Operators Station (EPOS) operator screens provide a crisp, clear, more detailed display for the operator to monitor production uniformity. Additionally, the modular electronics design will allow for optional connections to nearly every type of control and/or data archiving system. The electronics is based on a flexible platform that can be used for Isotope, X-ray and Infrared gauge upgrades.

The Electronics Upgrade Package can also be produced in a multiple configuration, permitting the use of two or more C-frames/O-frame scanners and the computer electronics cabinet for enhanced cost effectiveness.

Electronics Upgrade

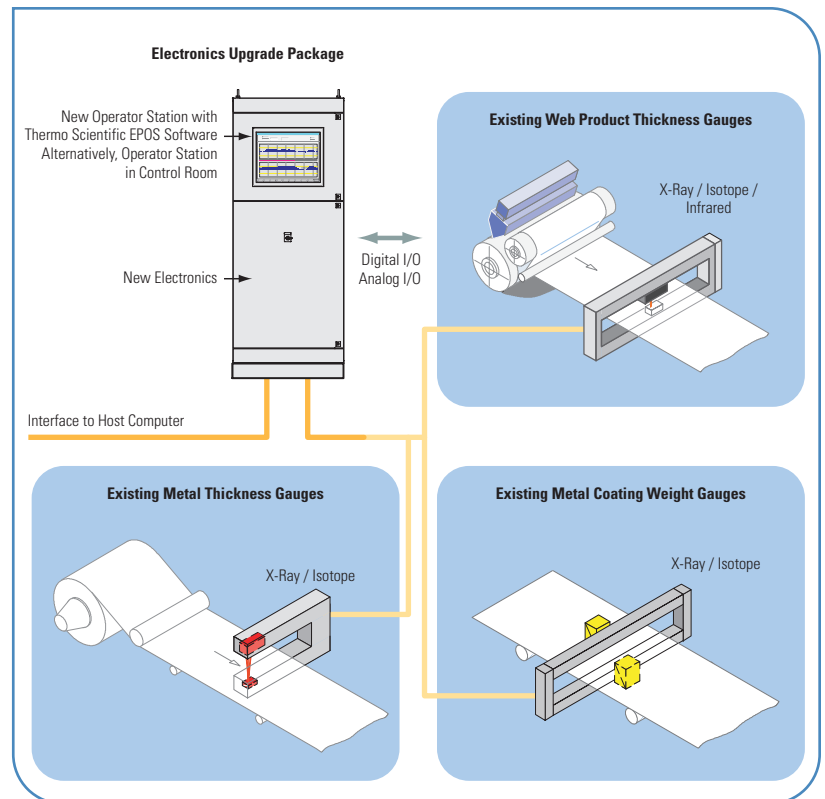

Thermo Scientific EPOS Operator Interface

The operator screens of the Electronic Upgrade Package are application oriented and are designed to provide the operator with a high contrast visual representation of the sensor measurements.

The monitor pages of the operator station are divided into logical groups that occur in the navigation bar. These groups are:

- Data Input: Pages with product dependent input parameters.
- Operation: Pages with buttons necessary for operation of the gauge.
- Measured Values: Pages with measured value displays like actual/averaged cross profile (only for scanning gauges), trend diagram, histogram, bargraph, and large measured value display.
- Reports: Display of measured values of the last product/the last roll with statistical values (minimum, maximum, average, 2-sigma, start time, end time, length in tolerance, length with +tolerance exceeded, length with -tolerance exceeded).

- Configuration: Pages with configuration parameters, parameters for the measuring mechanism, filter parameters.
- Service: Message list (error messages), analogue and digital Input/Output.

The EPOS operator interface uses the Windows® XP operating system. This allows for the individually designed and application adapted presentation of all important data for quality control, operation and process control. The Windows operating system enables EPOS to interface with standard applications like Microsoft Word, Microsoft Excel®, or Microsoft Access™ (option). Furthermore, the Microsoft ActiveX® technology is supported.

Further features of EPOS include:

- Clear, user-friendly operation via mouse, keyboard, touch screen, or virtual keyboard (soft-keyboard)
- Numerical display of the values shown as graphics in the diagrams (profile, trends, and histogram)

- Language Manager: Language (all 8 bit/character sets) of the operator interface can be changed during operation.
- Level Manager: For security purposes, every action/function is set to an access level (administrator, maintenance, and user 1-3).
- Print Manager: For configuration of report printing options. Automatic printouts (driven by events), manual hardcopies of selected pages or PDF files can be generated. Customer's network printer can be used (if customer's network is connected with the gauge).
- Product Data Memory: For storage and preparation of product data sets.
- Buttons bar for fast access to the print menu, language selection, page navigation, product data memory, and the soft-keyboard.

©2007 Thermo Fisher Scientific Inc. All rights reserved. Microsoft, Windows, ActiveX, Excel and Access are either trademarks or registered trademarks of Microsoft Corporation in the United States and/or other countries. All other trademarks are the property of Thermo Fisher Scientific Inc. and its subsidiaries. Results may vary under different operating conditions. Specifications, terms and pricing are subject to change. Not all products are available in all countries. Please consult your local sales representatives for details. Literature Code PI.9027.1007

China
+86 (0) 21 6865 4588
+86 (0) 21 6445 1101 fax

Germany
+49 (9131) 998-0
+49 (9131) 998-230 fax

Latin America
+52 (81) 8400-7375
+52 (81) 1257-6440 fax

USA
+1 (800) 488-4399
+1 (858) 452-9250 fax

France
+33 (0) 160 92 48 00
+33 (0) 160 92 49 00 fax

India
+91 (20) 6626 7000
+91 (20) 6626 7001 fax

United Kingdom
+44 (1452) 337-800
+44 (1452) 415-156 fax

www.thermo.com/metals