

**TUBE AND BOTTLE COVER ASSEMBLIES**

(Sealing and Nonsealing)

**FOR OAK RIDGE BOTTLES: In SUPERSPEED and LOWSPEED Rotors**

SEALING ASSEMBLY—Screw Cap Sealing Assembly for liquid seal in Fixed-Angle or Swinging-Bucket Rotor full volume applications.

NOMINAL BOTTLE VOLUME (ml)	BOTTLE CAT. NO.		PP SEALING ASSEMBLY CAT. NO. (Qty/Pkg)	REPLACEMENT O-RINGS	
	PP	PC		MATERIAL	CAT. NO. (Qty/Pkg)
10	03929	03020	<b>03279</b> (25)	Neoprene	<b>03689</b> (25)
30	03718	03719	<b>03276</b> (25)	Neoprene	<b>03688</b> (25)
50	03530	03480	<b>03535</b> (25)	Neoprene	<b>03540</b> (25)
250	03937	03939	<b>03278</b> (12)	Buna N	<b>03691</b> (24)
500	03943	03944	<b>03280</b> (12)	Buna N	<b>03693</b> (24)
1,000	03695	03947	<b>03280</b> (12)	Buna N	<b>03693</b> (24)



NONSEALING ASSEMBLY—Yellow Screw Cap for Swinging-Bucket Rotors or for less than full volume applications in Fixed-Angle Rotors.

NOMINAL BOTTLE VOLUME (ml)	BOTTLE CAT. NO.		PP NONSEALING CAP ASSEMBLY CAT. NO. (Qty/Pkg)
	PP	PC	
10	03929	03020	<b>03924</b> (25)
30	03718	03719	<b>03925</b> (25)
250	03937	03939	<b>03927</b> (12)
500	03943	03944	<b>03928</b> (12)
1,000	03695	03947	<b>03928</b> (12)



**FOR OAK RIDGE BOTTLES: In ULTRASPEED, SUPRASPEED® and SUPERSPEED Rotors**

Sealing Cap Assembly for full volume applications.

NOMINAL BOTTLE VOLUME (ml)	BOTTLE CAT. NO.		SEALING CAP ASSEMBLY		REPLACEMENT O-RINGS	
	PP	PC	DESCRIPTION	CAT. NO. (Qty/Pkg)	MATERIAL	CAT. NO. (Qty/Pkg)
10	03929	03020	Screw Cap, Orange Nylon	<b>03613</b> (25)	Neoprene	<b>03689</b> (25)
30	03718	03719	Screw Cap, Orange Nylon	<b>03614</b> (25)	Neoprene	<b>03688</b> (25)
50	03530	03480	Screw Cap, Purple Polypropylene	<b>03535</b> (25)	Neoprene	<b>03540</b> (25)
75	—	03232	Screw Cap, Black Noryl®	<b>00665</b> (1)	Neoprene	<b>03986</b> (12)
250	—	54477 Polyallomer	Screw Cap, White Delrin®	<b>54421</b> (1)	—	—

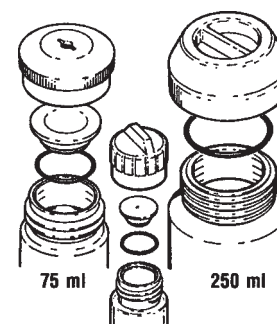

**DRY-SPIN BOTTLES**

SEALING ASSEMBLY—Screw Cap Sealing Assembly for liquid seal in Fixed-Angle Rotor full volume applications.

NOMINAL BOTTLE VOLUME (ml)	BOTTLE CAT. NO.		PP SCREW CAP ASSEMBLY		REPLACEMENT O-RINGS		REPLACEMENT CAPS	
	PP	PC	DESCRIPTION	CAT. NO.	MATERIAL	CAT. NO. (Qty/Pkg)	MATERIAL	CAT. NO. (Qty/Pkg)
250	03069	03098	Included with bottle	—	Buna N	<b>03545</b> (24)	PP	<b>06841</b> (12)
500	06829	—	Included with bottle	—	Buna N	<b>03545</b> (24)	PP	<b>06841</b> (12)

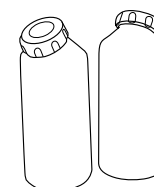

All trademarks are the property of their respective owners.

**TUBE AND BOTTLE COVER ASSEMBLIES** (continued)  
(Sealing and Nonsealing)

**FOR THREADED TUBES: In ULTRASPEED and SUPRASPEED® Rotors**

Aluminum Sealing Cap Assembly for full volume applications.

NOMINAL TUBE VOLUME (ml)	TUBE CAT. NO.	SEALING CAP ASSEMBLY CAT. NO. (Qty/Pkg)	TOOLS REQUIRED		REPLACEMENT O-RINGS	
			DESCRIPTION	CAT. NO.	MATERIAL	CAT. NO. (Qty/Pkg)
4.4	54361	54365 (1)	Tube Cap Tool (Included in Tool Kit Cat. No. 54380 for TFT-80.4 Rotor).	54377	Viton®	54333 (1)



**FOR FLANGED AND STAINLESS STEEL TUBES AND BOTTLES: In SUPERSPEED and LOWSPEED Rotors**

Stainless Steel Sealing Covers for **Stainless Steel** tubes and bottles. Autoclavable.

NOMINAL TUBE/BOTTLE VOLUME (ml)	TUBE/BOTTLE CAT. NO.	SEALING ASSY. CAT. NO. (Qty/Pkg)	REPLACEMENT PARTS		TOOLS REQUIRED		NOTES
			DESCRIPTION	CAT. NO. (Qty/Pkg)	Description	CAT. NO.	
50	00517 00579	00518 (1)	Washer, Neoprene	03665 (12)	Wrench	01014	Washer expands to form seal.
285	00530	Included with bottle	O-ring, Buna N	60869 (1)	—	—	Screw Cover, Standard O-ring.
315	00522	00518 (1)	Washer, Neoprene	03665 (12)	Wrench	01014	Washer expands to form seal.

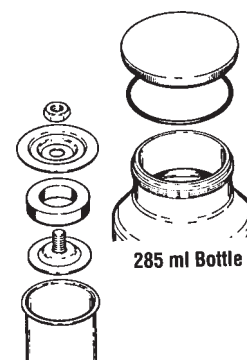

Nonsealing Covers for **Flanged** Tubes. Polypropylene, Autoclavable.

NOMINAL TUBE VOLUME (ml)	TUBE CAT. NO.		TUBE COVER CAT. NO. (Qty/Pkg)
	PP	PC	
4	03105	03104	03264 (50)
7	03121	03120	03265 (50)
12	03116	03115	03266 (50)
14	03247	03246	03269 (50)
16	03244	03243	03269 (50) (PC only)
			03299 (50) (PP only)
50	03147	03146	03268 (25)



**For ULTRACRIMP® and CLEARCRIMP® Tubes: In ULTRASPEED, SUPRASPEED® and SUPERSPEED Rotors**

Mechanical Crimp Sealing System. Polypropylene Plugs and Aluminum Caps are packaged with ULTRACRIMP® and CLEARCRIMP® tubes. Tube Racks, Rotor Caps and Sealing Tool must be purchased separately.

Catalog No. **03920**: ULTRACRIMP® and CLEARCRIMP® Sealing Tool and Crimp Gauge

Catalog No. **03919**: Crimp Gauge, Replacement

Catalog No. **12770**: Tool Kit for SV-288, SV-80, TV-865 and TV-1665 Vertical Rotors, Includes: Rotor Holding Fixture **52540**; Torque Wrench **52580**; Socket **52882**

Catalog No. **12771**: Tool Kit for TV-865B, TV-860, and TV-850 Vertical Rotors, Includes: Rotor Holding Fixture **52540**; Socket **54519**; Torque Wrench **52580**



## TUBE AND BOTTLE COVER ASSEMBLIES (continued)

### ORDERING INFORMATION

Complete system consists of Crimper, tubes, rotor caps (if needed) and racks. Order as follows:

SORVALL® CRIMPER                      Cat. No. **03920**

### ROTOR COMPATIBILITY with ULTRACRIMP® and CLEARCRIMP® Tubes

Nominal Tube Volume	Compatible Rotor	Rotor Caps <sup>1</sup>	Extra Plugs/ Tube Caps <sup>2</sup>	Required Adapters
■ 2 ml PA - Cat. No. 06708	S-120VT RP-120VT RP-100VT	Cat. No. 06797 Cat. No. 06797 Cat. No. 06797	Cat. No. 03999 Cat. No. 03999 Cat. No. 03999	
■ 2 ml PA - Cat. No. 79251 PET - Cat. No. 79292	STEPSAVER™ 70 V6	N/A	Cat. No. 03999 for PA Cat. No. 03044 for PET	Requires Cartridge Cat. No. 79261
■ 3.5 ml PA - Cat. No. 03905	F-28/13 F-28/36 TFT-80.4	Cat. No. 03091 Cat. No. 03091 Cat. No. 03091	Cat. No. 03999 Cat. No. 03999 Cat. No. 03999	Requires Adapter Cat. No. 02203 Requires Adapter Cat. No. 02208
■ 4.5 ml PA - Cat. No. 03728	AH-650	N/A	Cat. No. 03044	
■ 5 ml PA - Cat. No. 03898	SV-80	Cat. No. 03092	Cat. No. 03999	
■ 6 ml PA - Cat. No. 03945 PET - Cat. No. 01086	F-28-13 F-28/36 TV-1665 TV-865 TFT-45.6	Cat. No. 03992 Cat. No. 03992 Cat. No. 03991 Cat. No. 03991 Cat. No. 03992	Cat. No. 03999 Cat. No. 03999 Cat. No. 03999 Cat. No. 03999 Cat. No. 03999	Requires Adapter Cat. No. 02204 Requires Adapter Cat. No. 02209
■ 6 ml PA - Cat. No. 79273 PET - Cat. No. 79293	STEPSAVER™ 70 V6 STEPSAVER™ 65 V13	N/A	Cat. No. 03999  Cat. No. 03999	Requires Cartridge Cat. No. 79260 Requires Cartridge Cat. No. 79250
■ 11 ml PA - Cat. No. 03328	TH-641	N/A	Cat. No. 03045	
■ 11.5 ml PA - Cat. No. 03987 PET - Cat. No. 01087	F-28/13 F-28/36 T-890 T-880 TFT-80.13 T-875 T-1270 T-865 T-865.1 TFT-65.13 A-841 A-1256	Cat. No. 03993 Cat. No. 03993 Cat. No. 03993 Cat. No. 03993 Cat. No. 03993 Cat. No. 03993 Cat. No. 03993 Cat. No. 03993 Cat. No. 03993 Cat. No. 03993 Cat. No. 03993 Cat. No. 03993	Cat. No. 03999 Cat. No. 03999 Cat. No. 03999 Cat. No. 03999 Cat. No. 03999 Cat. No. 03999 Cat. No. 03999 Cat. No. 03999 Cat. No. 03999 Cat. No. 03999 Cat. No. 03999 Cat. No. 03999	Requires Adapter Cat. No. 02210  Requires Adapter Cat. No. 00399 Requires Adapter Cat. No. 00399
■ 13.5 ml PA - Cat. No. 79246 PET - Cat. No. 79294	STEPSAVER™ 65 V13 STEPSAVER™ 50 V39	N/A	Cat. No. 03999  Cat. No. 03999	Requires Cartridge Cat. No. 79263 Requires Cartridge Cat. No. 79244
■ 15.5 ml PA - Cat. No. 03409	AH-629 (17 ml) S-20/17	N/A	Cat. No. 03046	
■ 18.5 ml PA - Cat. No. 03988	TV-865B	Cat. No. 03994	Cat. No. 03999	
■ 33 ml PA - Cat. No. 03899	SV-288	Cat. No. 03995	Cat. No. 03999	
■ 34 ml PA - Cat. No. 03469	AH-629 (36 ml) S-20/36	N/A	Cat. No. 03047	
■ 35 ml PA - Cat. No. 03989	F-28/36 T-865 TFT-50.38 T-1250 TV-850 TV-860 A-841	Cat. No. 03996 Cat. No. 03996 Cap Not Available Cat. No. 03996 Cat. No. 03994 Cat. No. 03994 Cat. No. 03996	Cat. No. 03999 Cat. No. 03999 Cat. No. 03999 Cat. No. 03999 Cat. No. 03999 Cat. No. 03999 Cat. No. 03999	
■ 39 ml PA - Cat. No. 79253 PET - Cat. No. 79295	STEPSAVER™ 50 V39	N/A	Cat. No. 03047	Requires Cartridge Cat. No. 79248
■ 50 ml PA - Cat. No. 03528	F-28-50 SS-34 SA-600	Cat. No. 03538 Cat. No. 03538 Cat. No. 03538	Cat. No. 03999 Cat. No. 03999 Cat. No. 03999	
■ 90 ml PA - Cat. No. 03990	A-641 T-647.5	Cat. No. 03998 Cat. No. 03998	Cat. No. 03999 Cat. No. 03999	



**For Fixed-Angle and Vertical Rotors**



**For Swinging-Bucket and 50 V39 Rotors**

Notes: PA refers to Polyallomer ULTRACRIMP® tubes

PET refers to Polyethyleneterephthalate CLEARCRIMP® tubes

<sup>(1)</sup>A rotor cap is needed to support the top of the tube while it is in a Fixed-Angle or Standard Vertical rotor. Swinging-Bucket and StepSaver® rotors do not require a rotor cap. If you already have the proper caps, it is not necessary to order additional ones.

<sup>(2)</sup>ULTRACRIMP® and CLEARCRIMP® tubes are supplied with an equivalent number of tube caps and plugs. Additional tube caps and plugs are available, 25 per package.

**TUBE AND BOTTLE COVER ASSEMBLIES** (continued)

**RACKS for ULTRACRIMP® and CLEARCRIMP® Tubes**

Nominal Tube Volume (ml)	Rack Needed*	Nominal Tube Volume (ml)	Rack Needed*
2 ml (11 × 37)	Cat. No. 06822	15.5 ml	Cat. No. 03327
2 ml (13 × 45)	Cat. No. 79242	13.5 ml	Cat. No. 79247
3.5 ml	Cat. No. 03773	18.5 ml	Cat. No. 03923
4.5 ml	Cat. No. 03730	33 ml	Cat. No. 03763
5 ml	Cat. No. 03768	34 ml	Cat. No. 03539
6 ml	Cat. No. 03921	35 ml	Cat. No. 03935
11 ml	Cat. No. 03726	50 ml	Cat. No. 03529
11.5 ml	Cat. No. 03922	90 ml	Cat. No. 03940
39 ml	Cat. No. 79249		

\* If you already have the proper racks, it is not necessary to order additional ones.

**StepSaver® Cartridge Racks**

ROTOR	RACK
70 V6	<b>79211</b>
65 V13	<b>79212</b>
50 V39	<b>79288</b>

**Starter Kits**

ROTOR	CAT. NO.
150/100/20AT	<b>45305</b>
RP80AT/S80-AT5/6	<b>45320</b>
S80-AT3	<b>45700</b>

**S150-AT  
RP120-AT  
RP100-AT  
RP100-AT4  
RP80-AT  
S100-AT4  
S100-AT6  
S100-AT5**

**S120-VT  
RP120-VT  
RP100-VT**

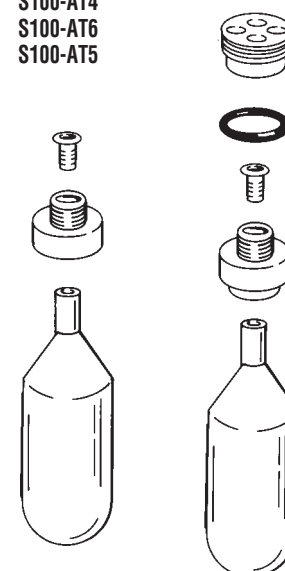

**FOR RE-SEAL™ TUBES: In MICRO-ULTRACENTRIFUGE Rotors**

Multipiece Sealing Assemblies.

NOMINAL TUBE VOLUME (ml)	TUBE CAT. NO.	SEALING ASSEMBLY		TOOLS REQUIRED		NOTES
		DESCRIPTION	CAT. NO. (Qty/Pkg)	DESCRIPTION	CAT. NO.	
1.5	9013 <sup>1</sup>	Crown	<b>4255<sup>1</sup></b> (1)	Wrench	<b>4088<sup>1</sup></b>	For S150-AT, RP120-AT, RP100-AT, and S120-AT2 Rotors. Aluminum Crown and Stainless Steel Plug.
		Plug	<b>4075<sup>1</sup></b> (10)	Removal Tool	<b>4077<sup>1</sup></b>	
2.0 (11 × 32)	45246	Crown	<b>45306</b> (1)	Wrench	<b>45308</b>	For RP120-VT, RP100-VT, S120-VT, RP120-AT, RP100-AT, S150-AT and S120-AT2 Rotors. Aluminum Crown and Rotor Cap, Stainless Steel Plug, and Buna N O-ring.
		Plug	<b>45307</b> (10)	Removal Tool	<b>45309</b>	
		Rotor Cap*	<b>45311</b> (1)	Rotor Cap Wrench*	<b>45271</b>	
2.0 (13 × 25)	9026 <sup>1</sup>	Crown	<b>4256<sup>1</sup></b> (1)	Torque Wrench*	<b>45483</b>	For RP100-AT4 and S100-AT4 Rotors. Aluminum Crown and Stainless Steel Plug.
		Plug	<b>4075<sup>1</sup></b> (10)	Vise	<b>45537</b>	
3.5	45247	Crown	<b>4256<sup>1</sup></b> (1)	Wrench	<b>45308</b>	For RP100-AT4 and S100-AT4 Rotors. Aluminum Crown and Stainless Steel Plug.
		Plug	<b>45307</b> (10)	Removal Tool	<b>45309</b>	
5.0	45248	Crown	<b>45321</b> (1)	Vise	<b>45535</b>	For RP-80AT, S100-AT6 and S100-AT5 Rotors. Aluminum Crown and Stainless Steel Plug.
		Plug	<b>45307</b> (10)	Wrench	<b>45308</b>	

\* These parts are for vertical rotors only.

<sup>(1)</sup> Available from Seton Scientific. In U.S. contact Seton at 1-800-543-2134.

All trademarks are the property of their respective owners.

**TUBE AND BOTTLE COVER ASSEMBLIES** (continued)

**FOR EASY-SEAL™ TUBES: In MICRO-ULTRACENTRIFUGE Rotors**

Multipiece Sealing Assemblies.

NOMINAL TUBE VOLUME (ml)	TUBE CAT. NO.	SEALING ASSEMBLY		TOOLS REQUIRED		NOTES
		DESCRIPTION	CAT. NO. (Qty/Pkg)	DESCRIPTION	CAT. NO.	
1.5	6011 <sup>1</sup> 8011 <sup>1</sup>	Crown Assembly	4264 <sup>1</sup> (1)	Crown Clamp Removal Tool Hex Driver Tube Vise	4269 <sup>1</sup> 4014 <sup>1</sup> 4189 <sup>1</sup> 4172 <sup>1</sup>	For RP-120AT, S120-AT2, S150-AT and RP 100-AT Rotors. Aluminum Crown and O-ring and Delrin® Plug.
1.5	6020 <sup>1</sup>	Crown Assembly	4267 <sup>1</sup> (1)	Crown Clamp Removal Tool Hex Driver Tube Vise	4269 <sup>1</sup> 4014 <sup>1</sup> 4189 <sup>1</sup> 4172 <sup>1</sup>	For RP-100AT4, S100-AT5, S100-AT4, S100-AT6 and RP80-AT Rotors. Aluminum Crown and O-ring and Delrin® Plug.
3.5	6021 <sup>1</sup> 8021 <sup>1</sup>	Crown Assembly	4267 <sup>1</sup> (1)	Crown Clamp Removal Tool Hex Driver Tube Vise	4269 <sup>1</sup> 4014 <sup>1</sup> 4189 <sup>1</sup> 4172 <sup>1</sup>	For RP-100AT4, S100-AT5, S100-AT4, S100-AT6 and RP80-AT Rotors. Aluminum Crown and O-ring and Delrin® Plug.
5.0	6022 <sup>1</sup>	Crown Assembly	4267 <sup>1</sup> (1)	Crown Clamp Removal Tool Hex Driver Tube Vise	4269 <sup>1</sup> 4014 <sup>1</sup> 4189 <sup>1</sup> 4172 <sup>1</sup>	For S100-AT5, S100-AT6 and RP80-AT Rotors. Aluminum Crown and O-ring and Delrin® Plug.



<sup>(1)</sup> Available from Seton Scientific. In U.S. contact Seton at 1-800-543-2134.

All trademarks are the property of their respective owners.



**TUBE AND BOTTLE COVER ASSEMBLIES** (continued)

**FOR THIN-WALLED TUBES: In ULTRASPEED and SUPRASPEED® Fixed-Angle Rotors**  
 Multipiece Sealing Assemblies.

NOMINAL TUBE VOLUME (ml)	TUBE CAT. NO.	SEALING ASSY. CAT. NO. (Qty/Pkg)	REPLACEMENT PARTS		TOOLS REQUIRED		NOTES
			DESCRIPTION	CAT. NO.	DESCRIPTION	CAT. NO.	
6.5	03958	03948 (1)	O-ring	54388	Tool Kit, Includes: Tube Removal Tool Tube Cap Vise Torque Wrench 7/16 inch Socket	11537 11538 52176 52881 52882	For TFT-45.6 Rotor. Aluminum Plug and Cover.
12.5	03128	52178 (1)	Post Fill Screw Hex Nut Cover O-ring Plug	65987 52148 52146 66311 52438	Tool Kit, Includes: Tube Cap Vise Tube Removal Tool Torque Wrench 7/16-inch Socket	52609 52176 52177 52881 52882	For T-865.1 and A-1256 Rotors. Aluminum Plug and Cover.
12.5	03128	52634 (1)	Post Fill Screw Hex Nut Cover O-ring Plug	65987 52615 52619 66311 52641	Tool Kit, Includes: Tube Cap Vise Tube Removal Tool Torque Wrench 7/16-inch Socket	52609 52176 52177 52881 52882	For T-875 and T-1270 Rotors. Titanium Plug and Cover.
13.5	03961 03962 54399	54416 (1)	O-ring	54436	Tool Kit, Includes: Tube Removal Tool Tube Cap Vise Vise Insert Torque Wrench 7/16-inch Socket	11538 54382 54451 52881 52882	Tubes Cat. No. 03961 and 03962 for TFA-20.250, TFT-65.13 and TFT-80.13 Rotors. Tube Cat. No. 54399 for TFA-20.250 only. Aluminum Plug and Cover.
13.5	03957 54397 54398	03977 (1)	O-ring	54352	Tool Kit, Includes: Tube Removal Tool Tube Cap Vise Vise Insert Torque Wrench 7/16-inch Socket	11538 54382 54451 52881 52882	Tubes Cat. No. 03957 for TFA-20.250 and TFT-80.13 Rotors. Tubes Cat. No. 54397 and 54398 for TFA-20.250 only. Titanium Plug and Cover.
13.5	03957 54397 54398	03949 (1)	O-ring	54352	Tool Kit, Includes: Tube Removal Tool Tube Cap Vise Vise Insert Torque Wrench 7/16-inch Socket	11538 54382 54451 52881 52882	Tubes Cat. No. 03957 for TFA-20.250 and TFT-65.13 Rotors. Tubes Cat. No. 54397 and 54398 for TFA-20.250 only. Aluminum Plug and Cover.
36	03141	52572 (1)	Post Fill Screw Hex Nut Plug Cover Plug Washer	65879 51840 51868 52436 51841	Tool Kit, Includes: Tube Vise Tube Removal Tool 3/4-inch Wrench	52610 51834 52013 66298	For T-865 and A-841 Rotors. Aluminum Plug and Cover.
38.5	03956	03950 (1)	O-ring	54335	Tool Kit, Includes: Tube Removal Tool Socket Torque Wrench Tube Cap Vise Vise Insert	54384 11538 11540 52881 54382 54383	For TFT-50.38 Rotor. Aluminum Plug and Cover.
94	54448 54452 54454	54419 (1)	O-ring	54438	Tool Kit, Includes: Tube Cap Vise Tube Removal Tool Torque Wrench Socket	54412 54382 11538 52881 11540	For TFA-20.250 Rotor. Aluminum Plug and Cover.
100	03140	52571 (1)	Post Fill Screw Nut Cover Plug Washer	65879 52017 52018 52437 52016	Tool Kit, Includes: Tube Vise Tube Removal Tool Torque Wrench 7/8-inch Socket	52988 51834 52013 52881 66376	For T-647.5 Rotor. Aluminum Plug and Cover.
100	03140	52571 (1)	Post Fill Screw Nut Cover Plug Washer	65879 52017 52018 52437 52016	Tool Kit, Includes: Tube Vise Tube Removal Tool 7/8-inch Socket	52631 51834 52013 66297	For A-641 Rotor. Aluminum Plug and Cover.

03948  
52178  
52634  
03977

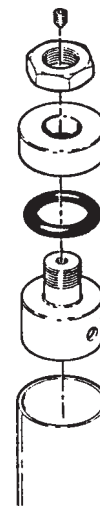

54416  
03949  
03950  
54419



52572  
52571



**TUBE AND BOTTLE COVER ASSEMBLIES** (continued)

**FOR CONE-TOP TUBES: In ULTRACENTRIFUGE Rotors**

Multipiece Sealing Assemblies.

NOMINAL TUBE VOLUME (ml)	TUBE CAT. NO.	SEALING ASSEMBLY		TOOLS REQUIRED		NOTES
		DESCRIPTION	CAT. NO. (Qty/Pkg)	DESCRIPTION	CAT. NO. (Qty/Pkg)	
— (11 × 32 mm)	9012 <sup>1</sup>	Crown, 11 mm	<b>4246</b> <sup>1</sup> (1)	Plug Wrench	<b>4088</b> <sup>1</sup> (1)	For TFT-80.4, TST-60.4 and TH-660 Rotors. Aluminum Crown and Stainless Steel Plug.
		Plug, Stainless Steel	<b>4075</b> <sup>1</sup> (10)	Removal Tool	<b>4077</b> <sup>1</sup> (1)	
2 (13 × 25 mm)	9024 <sup>1</sup>	Crown, 13 mm	<b>4247</b> <sup>1</sup> (1)	Plug Wrench	<b>4088</b> <sup>1</sup> (1)	For TFT-45.6 and AH-650 Rotors. Aluminum Crown and Stainless Steel Plug.
		Plug, Stainless Steel	<b>4075</b> <sup>1</sup> (10)	Removal Tool	<b>4077</b> <sup>1</sup> (1)	
3.5 (13 × 32 mm)	9025 <sup>1</sup>	Crown, 13 mm	<b>4247</b> <sup>1</sup> (1)	Plug Wrench	<b>4088</b> <sup>1</sup> (1)	For TFT-45.6 and AH-650 Rotors. Aluminum Crown and Stainless Steel Plug.
		Plug, Stainless Steel	<b>4075</b> <sup>1</sup> (10)	Removal Tool	<b>4077</b> <sup>1</sup> (1)	
5.9 (14 × 47 mm)	9032 <sup>1</sup>	Crown, 14 mm	<b>4219</b> <sup>1</sup> (1)	Plug Wrench	<b>4088</b> <sup>1</sup> (1)	For the TH-641 Rotor. Aluminum Crown and Stainless Steel Plug.
		Plug, Stainless Steel	<b>4075</b> <sup>1</sup> (10)	Removal Tool	<b>4077</b> <sup>1</sup> (1)	
6.3 (16 × 45 mm)	9040 <sup>1</sup>	Crown, 16 mm	<b>4248</b> <sup>1</sup> (1)	Plug Wrench	<b>4088</b> <sup>1</sup> (1)	For T-875, T-865.1, T-880, T-890, T-1270 and A-1256 Rotors. Aluminum Crown and Stainless Steel Plug.
		Plug, Stainless Steel	<b>4075</b> <sup>1</sup> (10)	Removal Tool	<b>4077</b> <sup>1</sup> (1)	



<sup>(1)</sup> Available from Seton Scientific. In U.S. contact Seton at 1-800-543-2134.

**TUBE AND BOTTLE COVER ASSEMBLIES** (continued)

**FOR THIN-WALLED TUBES: In Selected ULTRASPEED Rotors**

Selfseal Multipiece Assemblies.

NOMINAL TUBE VOLUME (ml)	TUBE CAT. NO.	SEALING ASSY. CAT. NO. (Qty/Pkg)	TOOLS REQUIRED		NOTES
			DESCRIPTION	CAT. NO.	
2	54460	<b>54459</b> (1)	Tube Removal Tool	<b>11538</b>	For TFT-80.2 Rotor. Aluminum Plug with Titanium Ring.
4.4	03955	<b>54366</b> (1)	Tool Kit, Includes: Tube Cap Vise Tube Removal Tool	<b>54380</b> 52176 11538	For TFT-80.4, F-28/13, and F-28/36 Rotors. Aluminum Plug with Titanium Ring.



**FOR THIN-WALLED POLYALLOMER TUBES: In Vertical Rotors**

Multipiece Sealing Assembly.

NOMINAL TUBE VOLUME (ml)	TUBE CAT. NO.	SEALING ASSEMBLY		TOOLS REQUIRED		NOTES
		DESCRIPTION	CAT. NO. (Qty/Pkg)	DESCRIPTION	CAT. NO.	
5	03127	Body Cap	<b>09116</b> (1)	Holding Fixture	<b>52540</b>	For SV-80 Rotor.
		Tube Plug for Polyallomer Tubes (White)	<b>52522</b> (8)	Wrench	<b>52363</b>	
5	03127	Body Cap	<b>52521</b> (1)	Tool Kit, Includes: Wrench	<b>52598</b>	For SV-80 & SV-288
		Tube Plug for Polyallomer Tubes (White)	<b>52522</b> (8)	Rotor Holding Fixture	52363 52540	
20	03288	Body Cap	<b>09082</b> (1)	Wrench	<b>09054</b>	For SV-288 Rotor.
		Tube Plug, Delrin®	<b>52482</b> (8)	Rotor Holding Fixture	<b>52540</b>	
				Optional Tube Trimmer	<b>52513</b>	
20	03288	Body Cap	<b>52556</b> (1)	Tool Kit, Includes: Rotor Holding Fixture	<b>52599</b>	For TV-850, TV-860 Rotors.
		O-ring	<b>52555</b> (16)	Plug Tool	52448	
		Tube Plug	<b>52557</b> (8)	Wrench Adapter	52577	
		Seal Ring	<b>52596</b> (8)	Torque Wrench	52580	
36	03141	Body Cap	<b>09082</b> (1)	Optional Tube Trimmer	<b>09073</b>	For SV-288 Rotor.
		Tube Plug, Delrin®	<b>52482</b> (8)	Wrench	<b>09054</b>	
				Rotor Holding Fixture	<b>52540</b>	
36	03141	Body Cap	<b>52556</b> (1)	Optional Tube Trimmer	<b>09073</b>	For TV-850, TV-860 Rotors.
		O-ring	<b>52555</b> (16)	Tool Kit, Includes: Rotor Holding Fixture	<b>52599</b>	
		Tube Plug	<b>52557</b> (8)	Plug Tool	52448	
		Seal Ring	<b>52596</b> (8)	Wrench Adapter	52577	
				Torque Wrench	52580	

TV-1665  
TV-865  
SV-80 &  
SV-288

TV-860  
TV-850 &  
TV-865B



**E**

All trademarks are the property of their respective owners.